

DJO Surgical Shoulder Solutions
Reaching Higher by Design

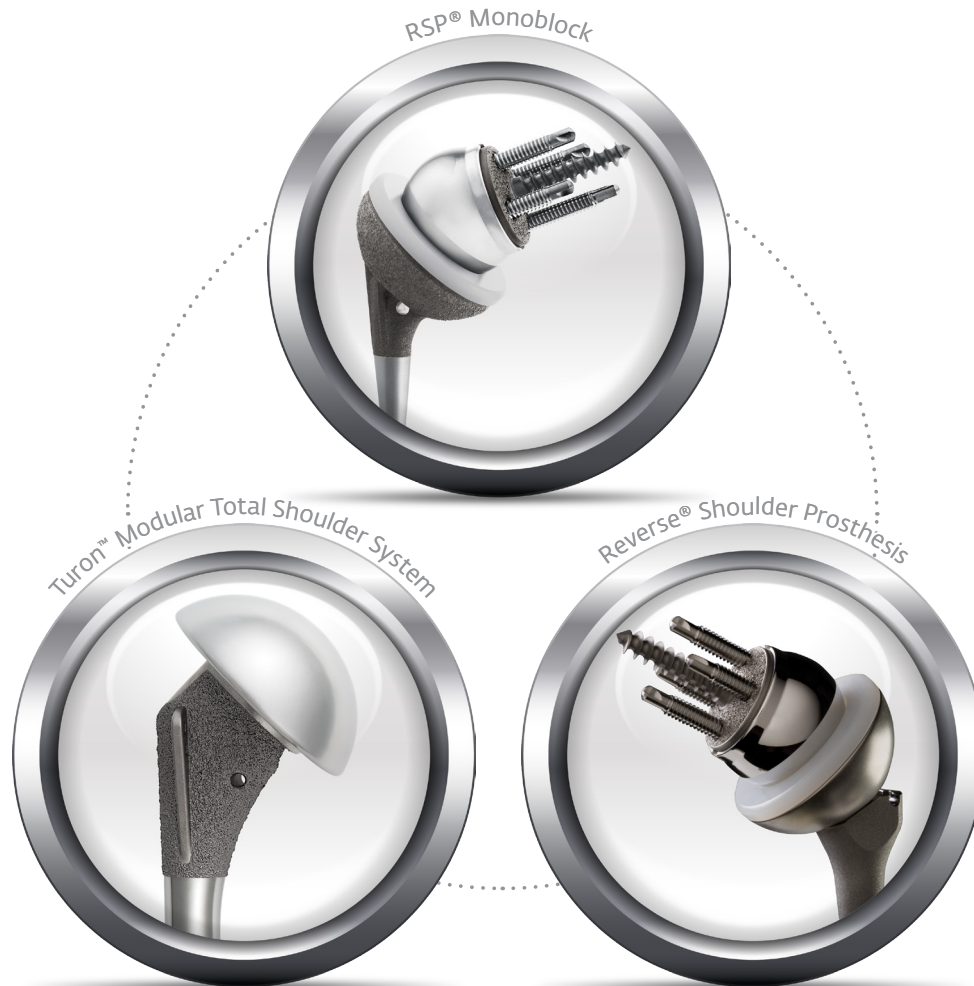

Reaching higher by design...

SO PATIENTS CAN, TOO.

At DJO Surgical, our end goal is to help patients reach their greatest potential. We strive to achieve this through innovation, proven results, and clinical heritage. Our approach is to partner with surgeon experts in the field to design shoulder systems that ultimately provide shoulder solutions. DJO Surgical Shoulder Solutions are anatomic designs engineered to provide optimized function, enhanced fixation, and flexibility and versatility to manage differing patient needs. Our aim is to reach new heights by providing clinicians solutions to help their patients reach higher.

djo *surgical*™

Anatomic Designs with Optimized Function

Whether it is total or reverse shoulder arthroplasty, DJO Surgical has a shoulder solution designed with the natural anatomy in mind. The goals are to restore patient anatomy, optimize joint stability, and improve range of motion.

Dial In to Motion

Turon™ is the first total shoulder system to incorporate the IMIN™ neck technology; a patented clocking feature that provides the ability to dial in the correct neck position. This, combined with neutral and eccentric humeral head sizing options, helps achieve the best implant fit with the optimal neck position and offset.

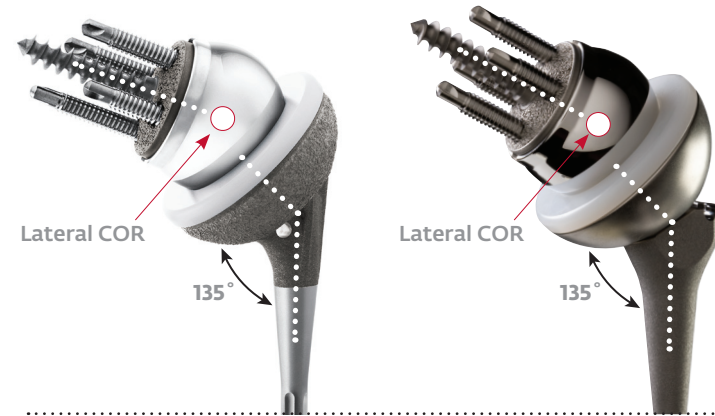

A Forward-Thinking Reverse

The Reverse Shoulder Prosthesis (RSP®) was the first reverse shoulder design to successfully incorporate a center of rotation (COR) lateral to the glenoid. It is also the only reverse shoulder to feature an anatomic humeral neck-shaft angle that through biomechanical testing has shown to help reduce the potential for inferior scapular notching.¹

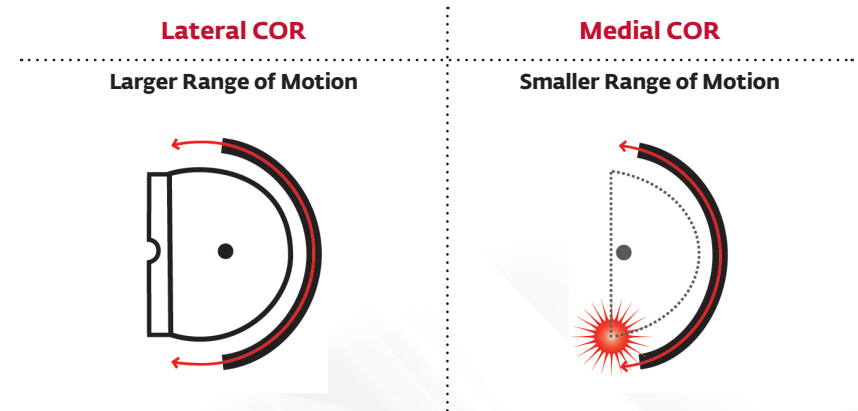

A lateral COR maximizes range of motion while reducing the potential for inferior scapular notching.

A medial COR reduces range of motion and creates the potential for inferior scapular notching.

Inferior scapular notching has been associated with poor clinical outcomes.²

Enhanced Fixation

A design philosophy of DJO Surgical Shoulder Solutions is for successful bony ingrowth, a stable interface between the bone and the prosthetic device is required during initial healing.

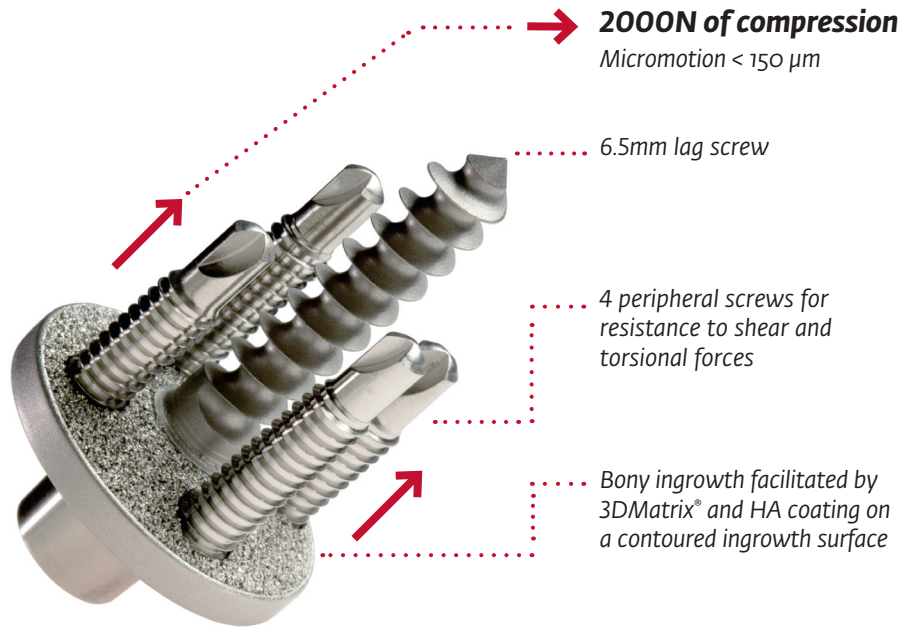

In the instance of the reverse shoulder, the design of the RSP baseplate provides 2000N of compression at the prosthesis-bone interface, leading to stable initial fixation as well as ideal conditions for bony ingrowth for long-term fixation.

Central Compression Peg

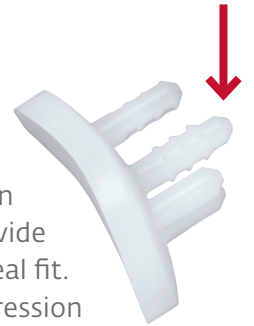

In the instance of the total shoulder, the Turon humeral stem features a tapered proximal body, anterior and posterior fins, in addition to, a proximal plasma spray to provide a locking and rotationally stable metaphyseal fit. The Turon pegged glenoid features a compression peg design to impart initial bony fixation.

Collar minimizes the risk of subsidence

Reduced lateral border avoids tuberosity interference

Proximal plasma spray provides a 0.5 mm press-fit

Anterior and Posterior fins promote rotational stability



Flexibility and Versatility

Both the Turon and RSP offer a wide variety of intra-operative options that help to manage complex anatomies and to achieve the best surgical outcomes.

The Turon shoulder features a wide variety of humeral stem, neck, head and glenoid options to provide intra-operative flexibility to suit different patient demands.

Stems
standard and revision (long)

Necks
angled neck –15° of variability
neutral neck

Heads
13 neutral and
12 offset (in 4mm) sizes

Glenoids
5 pegged and
5 keeled sizes

Intra-Operative Solutions
neutral head
neutral neck
pegged glenoid
offset head
angled neck
keeled glenoid

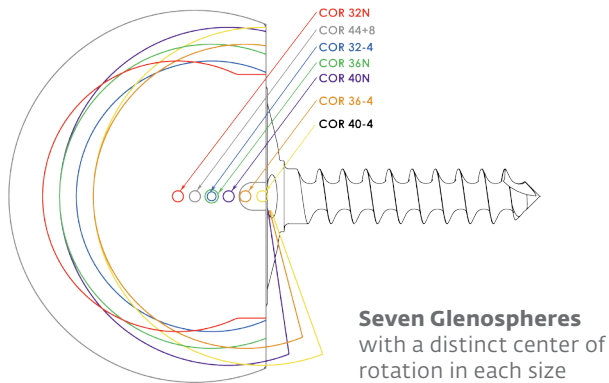

The RSP system offers unmatched versatility, in size and offset, of glenospheres to manage complex anatomy and surgical outcomes for rotator-cuff-deficient shoulders.



The RSP® Monoblock humeral stem builds on the foundation of the RSP. Designed to address proximal humeral fractures, the RSP Monoblock captures the advantages of the traditional RSP and has the benefit of expanded indications.

5 Diameter Sizes
Standard and revision lengths (175mm and 220mm)



Putting it all Together

DJO shoulder systems are designed to provide a complete and seamless shoulder solutions platform. Conversion Modules minimize the potential challenges of removing a well-fixed humeral stem by allowing conversion of a primary total shoulder to a reverse shoulder and a reverse shoulder to a hemi-arthroplasty prosthesis.

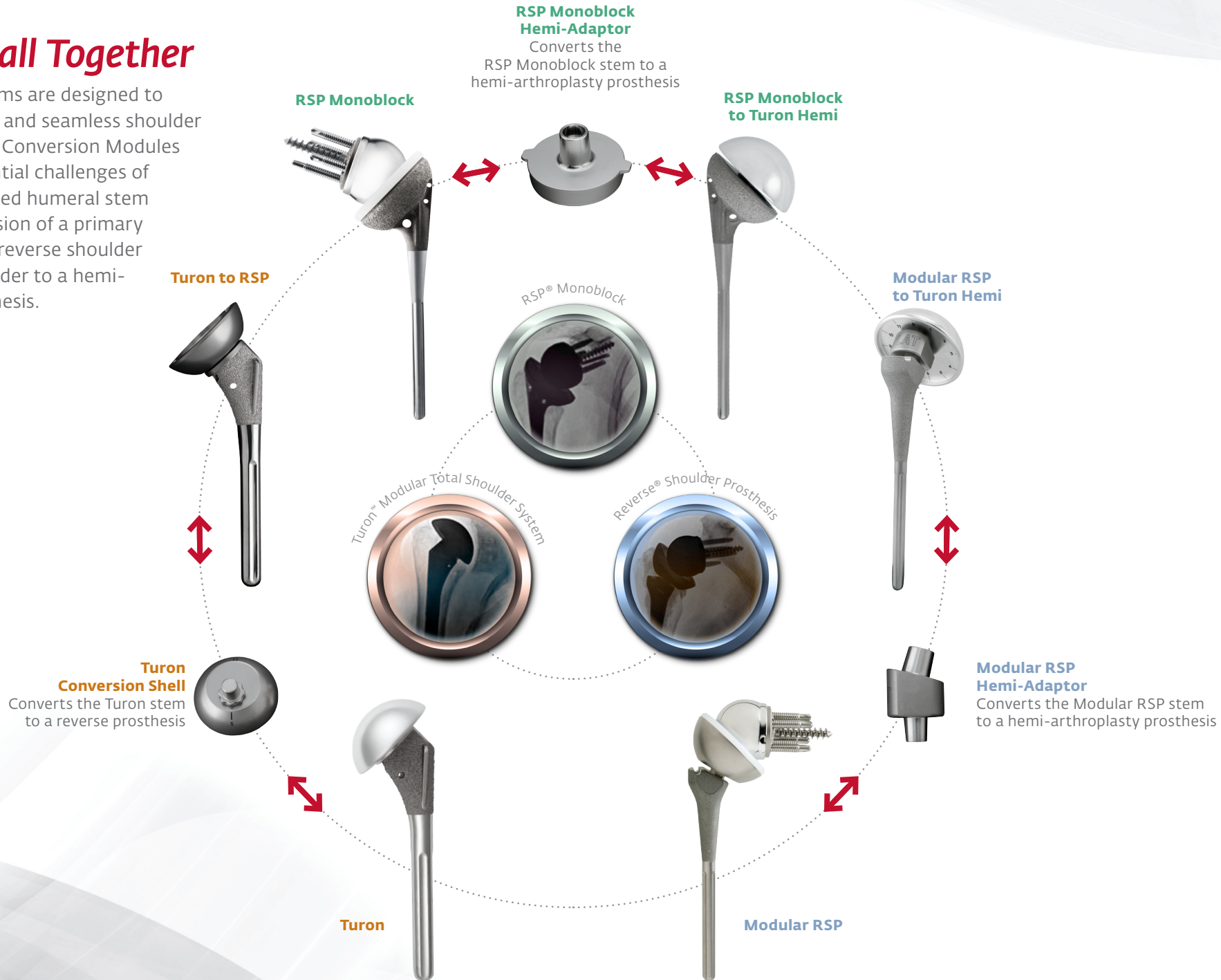

Proven Results

The Turon™ shoulder is benchmarked off of the design and principles of the Charles Neer shoulder prosthesis; and RSP is one of the most, well-published reverse shoulders on the market with over forty peer reviewed journal publications.*

*Abbreviated bibliography, complete bibliography on file at DJO Surgical.

Willis M, Walker M, Frankle M. Reverse Total Shoulder Arthroplasty. AAOS Monograph on Total Shoulder Arthroplasty. *Sanchez-Sotelo J, Ed.* In press.

Willis M, Min W, Brooks J, Mulieri P, Walker M, Pupello D, Frankle M. Proximal humeral malunion treated with reverse shoulder arthroplasty. *J Shoulder Elbow Surg.* In press.

Walker M, Willis M, Brooks J, Pupello D, Mulieri P, Frankle M. The use of the reverse shoulder arthroplasty for treatment of failed total shoulder arthroplasty. *J Shoulder Elbow Surg.* In press.

Zavala J, Clark J, Kissenberth M, Tolan S, Hawkins R. Management of deep infection after reverse total shoulder arthroplasty: a case series. *J Shoulder Elbow Surg.* 2011; Nov 18 [Epub ahead of print]

Clark J, Ritchie J, Song F, Kissenberth M, Tolan S, Hart N, Hawkins R. Complication rates, dislocation, pain and postoperative range of motion after reverse shoulder arthroplasty in patients with and without repair of the subscapularis. *J Shoulder Elbow Surg.* 2012 Jan;21(1):26-41. [Epub 2011 Jul 31]

Kwon YW, Pinto VJ, Yoon J, Frankle MA, Dunning PE, Sheikhzadeh A. Kinematic analysis of dynamic shoulder motion in patients with reverse total shoulder arthroplasty. *J Shoulder Elbow Surg.* 2011 Oct 29. [Epub ahead of print]

Harrelld K, Puskas B, Frankle M. Massive rotator cuff tears without arthroplasty: When to consider reverse shoulder arthroplasty. *J Bone Joint Surg Am.* 2011;93:973-984.

Cheung EV, Willis M, Walker M, Clark R, Frankle M. Complications in reverse shoulder arthroplasty. *JAAOS.* 2011;19:7.

Walker M, Willis M, Frankle M. How does reverse shoulder arthroplasty work? *CORR.* 2011;469(9):2440-51.

Gutiérrez S, Walker M, Willis M, Pupello DR, Frankle MA. Effects of tilt and glenosphere eccentricity on baseplate/bone interface forces in a computational model, validated by a mechanical model, of reverse shoulder arthroplasty. *J Shoulder Elbow Surg.* 2011 Jan 31. [Epub ahead of print]

Cuff D, Levy JC, Gutiérrez S, Frankle MA. Torsional stability of modular and non-modular reverse shoulder humeral components in a proximal humeral bone loss model. *J Shoulder Elbow Surg.* 2011 Jan 11. [Epub ahead of print]

Mulieri PJ, Dunning PE, Klein SM, Pupello DR, Frankle MA. Reverse shoulder arthroplasty for the treatment of irreparable rotator cuff tear without glenohumeral arthritis. *J Bone Joint Surg* 2010;92:2544-56.

Klein SM, Dunning P, Mulieri P, Pupello D, Downes K, Frankle MA. Effects of acquired glenoid bone defects on surgical technique and clinical outcomes in reverse shoulder arthroplasty. *J Bone Joint Surg Am* 2010;92:1144-54.

Holcomb JO, Hebert DJ, Mighell MA, Dunning PE, Pupello DR, Pliner MD, Frankle MA. Reverse shoulder arthroplasty in patients with rheumatoid arthritis. *J Shoulder Elbow Surg* 2010;19(7):1076-84.

Holcomb JO, Cuff D, Petersen SA, Pupello DR, Frankle MA. Revision reverse shoulder arthroplasty for glenoid baseplate failure after primary reverse shoulder arthroplasty. *J Shoulder Elbow Surg* 2009;18:717-23.

Holcomb J, Pupello D, Levy J, Cuff D, Frankle M. Challenging the conclusion, "Clinical outcome was essentially not affected by the notch". *J Shoulder Elbow Surg* 2009;18:e51-2; author reply e2-3.

Gutierrez S, Luo ZP, Levy J, Frankle MA. Arc of motion and socket depth in reverse shoulder implants. *Clin Biomech (Bristol, Avon)* 2009;24:473-9.

Levy JC, Virani N, Pupello D, Frankle M. Use of the reverse shoulder prosthesis for the treatment of failed hemiarthroplasty in patients with glenohumeral arthritis and rotator cuff deficiency. *J Bone Joint Surg Br* 2007;89:189-95.

Levy J, Frankle M, Mighell M, Pupello D. The use of the reverse shoulder prosthesis for the treatment of failed hemiarthroplasty for proximal humeral fracture. *J Bone Joint Surg Am* 2007;89:292-300.

Gutierrez S, Greiwe RM, Frankle MA, Siegal S, Lee WE, 3rd. Biomechanical comparison of component position and hardware failure in the reverse shoulder prosthesis. *J Shoulder Elbow Surg* 2007;16:S9-S12.

Frankle M, Mighell M. Re: Shoulder prostheses treating cuff tear arthroplasty: a comparative biomechanical study. *J Orthop Res* 2006;24:112; author reply -3.

Frankle M, Levy JC, Pupello D, Siegal S, Saleem A, Mighell M, Vasey M. The reverse shoulder prosthesis for glenohumeral arthritis associated with severe rotator cuff deficiency: a minimum two-year follow-up study of sixty patients surgical technique. *J Bone Joint Surg Am* 2006;88 Suppl 1 Pt 2:178-90.

Harman M, Frankle M, Vasey M, Banks S. Initial glenoid component fixation in "reverse" total shoulder arthroplasty: a biomechanical evaluation. *J Shoulder Elbow Surg* 2005;14:162S-7S.

Frankle M, Siegal S, Pupello D, Saleem A, Mighell M, Vasey M. The Reverse Shoulder Prosthesis for glenohumeral arthritis associated with severe rotator cuff deficiency: A minimum two-year follow-up study of sixty patients. *J Bone Joint Surg Am* 2005;87:1697-705.

Frankle M, Kumar A. Reverse total shoulder replacement for arthritis with an irreparable rotator cuff tear. *Techniques in Shoulder & Elbow Surgery* 2003;4:77-83.

Frankle MA, Teramoto A, Luo ZP, Levy JC, Pupello D. Glenoid morphology in reverse shoulder arthroplasty: classification and surgical implications. *J Shoulder Elbow Surg* 2009;18:874-85.

Chacon A, Virani N, Shannon R, Levy JC, Pupello D, Frankle M. Revision arthroplasty with use of a reverse shoulder prosthesis-allograft composite. *J Bone Joint Surg Am* 2009;91:119-27.

Virani NA, Harman M, Li K, Levy J, Pupello DR, Frankle MA. In vitro and finite element analysis of glenoid bone/baseplate interaction in the reverse shoulder design. *J Shoulder Elbow Surg* 2008;17:509-21.

Gutierrez S, Levy JC, Frankle MA, Cuff D, Keller TS, Pupello DR, Lee WE, 3rd. Evaluation of abduction range of motion and avoidance of inferior scapular impingement in a reverse shoulder model. *J Shoulder Elbow Surg* 2008;17:608-15.

Gutierrez S, Comiskey CA, Luo ZP, Pupello DR, Frankle MA. Range of impingement-free abduction and adduction deficit after reverse shoulder arthroplasty. Hierarchy of surgical and implant-design-related factors. *J Bone Joint Surg Am* 2008;90:2606-15.

Cuff DJ, Virani NA, Levy J, Frankle MA, Derasari A, Hines B, Pupello DR, Cancio M, Mighell M. The treatment of deep shoulder infection and glenohumeral instability with debridement, reverse shoulder arthroplasty and postoperative antibiotics. *J Bone Joint Surg Br* 2008;90:336-42.

Cuff D, Pupello D, Virani N, Levy J, Frankle M. Reverse shoulder arthroplasty for the treatment of rotator cuff deficiency. *J Bone Joint Surg Am* 2008;90:1244-51.

References

1. Gutierrez S, Comiskey C, Lou Z, Pupello D, Frankle M. Range of Impingement-Free Abduction and Adduction Deficit After Reverse Shoulder Arthroplasty. Hierarchy of Surgical and Implant-Design-Related Factors. *J Bone Joint Surg Am.* 2008 Dec;90(12):2606-15.
2. Simovitch RW, Zumstein MA, Lohri E, Helmy N, Gerber C. Predictors of scapular notching in patients managed with the Delta III reverse total shoulder replacement. *J Bone Joint Surg Am.* 2007 Mar;89(3):588-600.



DJO Surgical | A DJO Global Company

T 800.456.8696 **D** 512.832.9500 **F** 512.834.6300

9800 Metric Blvd. | Austin, TX 78758 | U.S.A.

www.djoglobal.com/djosurgical

Together in Motion™

CAUTION: Federal Law (USA) restricts this device to sale by or on the order of a physician.
See package insert for a complete listing of indications, contraindications, warnings, and precautions.